

IMT Des Moines Marathon Scheels Sports and Fitness Expo

October 14 - 15, 2011
Polk County Convention Complex
Des Moines, IA

REVISION DATE:
9.6.2011 jlc

BOOTH COUNT

Inventory as of 09/06/2011

Dimension	Size	Qty	SqFt
10x10'	100	57	5,700
10x20'	200	4	800
20x20'	400	1	400
20x30'	600	1	600
30x30'	900	1	900
30x60'	1,800	1	1,800
Custom	730	1	730

Totals: 66 10,930

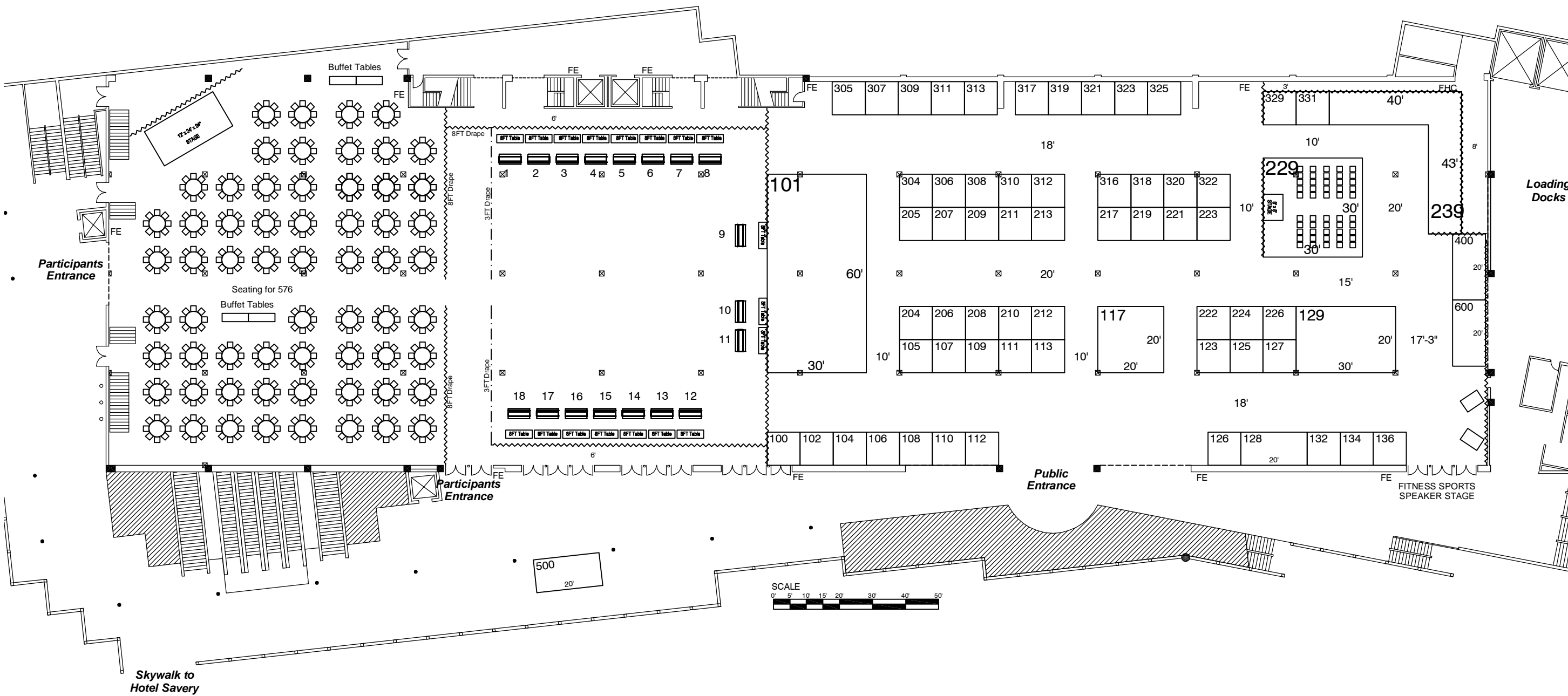

BLDG. LEGEND:



Floor Box Utility Key	
■	Electric, Phone
▲	Electric, Phone, Water & Drain
◆	Electric, Phone, Internet
◆	Electric, Phone, Internet, Water & Drain

FREEMAN

DRAWING STARTED:
9.6.2011 jlc
FILE PATH:
O:\Design\SHOWS\2011\10
October\IMT DM Marathon\IMTDM
2011 v03.dwg

DRAWING NAME:
IMTDM 2011 V03
HALL NAME:

PROJECT NUMBER:

ACCT. EXEC.:
Kirstein

NOT TO SCALE

DISCLAIMER

EVERY EFFORT HAS BEEN MADE TO ENSURE THE ACCURACY OF ALL INFORMATION CONTAINED ON THIS FLOORPLAN. HOWEVER NO WARRANTIES, EITHER EXPRESSED OR IMPLIED ARE MADE WITH RESPECT TO THIS FLOORPLAN. IF THE LOCATION OF BUILDING COLUMNS, UTILITIES OR OTHER ARCHITECTURAL COMPONENTS OF THE FACILITY IS A CONSIDERATION IN THE CONSTRUCTION OR USAGE OF AN EXHIBIT, IT IS THE SOLE RESPONSIBILITY OF THE EXHIBITOR TO PHYSICALLY INSPECT THE FACILITY TO VERIFY ALL DIMENSIONS AND LOCATIONS. COPYRIGHT 2007, FREEMAN CO. ALL RIGHTS RESERVED.

Skywalk to
Hotel Savery